

# CIRCLE OF FRIENDS

NEWSLETTER OF THE FRIENDS OF BONNECHERE PARKS

SPRING 1996

## Board of Directors

Betty Biesenthal  
Vicki Bradley  
Jane Duff  
Kerri Caroll  
Laurie Fraser  
Jerry Stokes  
Ross Taylor

## Slate of Officers

President: Betty Biesenthal  
Treasurer: Jane Duff  
Secretary: Laurie Fraser

## Committees Chairs

*Public Relations*  
Betty Biesenthal  
613-732-4321

*Fundraising and Grants*  
Laurie Fraser  
613-735-2283

*Cultural Resource Centre  
and Related Projects*  
Jim Fraser  
613-735-2283

*Book Store and Staffing*  
Vicki Bradley  
613-735-6627

*Park Superintendent*  
Jim Fraser

The Friends of  
Bonnechere Parks  
Box 220, Pembroke, ON  
K8A 6X4



*Plan your work and work your plan. The Friends are taking heed of this adage and organizing ourselves into a formal committee structure which sets out a specific set of goals, objectives and projects. When combined they comprise a formal working strategy for this dedicated group of volunteers and Park staff. A summary of the objectives reveals the overwhelming need to generate funds so we can protect and promote the Parks of the Bonnechere River. New volunteers are always needed, perhaps you can find a role for yourself within our organization.*

*While such efforts deal with what will keep us busy in the years to come, much of what we are currently focusing on is that which has occurred in the past. In particular, we are intent on preserving and presenting the colourful history of the watershed of the Little Bonnechere River. Whether it's publishing historical recollections or housing the precious artifacts of local archaeological digs, we believe that the historic culture and natural beauty which is the Bonnechere is ours to protect and everyone's to enjoy.*

*Keep in mind that springtime is membership season for the Friends of Bonnechere Parks. While the fees we collect are nominal, they do make a difference. We appreciate your support and encourage you to invite more people into our Circle of Friends.*

*Betty Biesenthal, Editor*

*The Friends of Bonnechere Parks Announce the Publication of:*

## Spirits of the Little Bonnechere

The Friends are pleased to announce the release of our premier historical publication: *Spirits of the Little Bonnechere*. With diary transcripts, personal recollections, photographs and illustrated maps, this book relates the story of the people who over generations explored, settled and worked in the valley of the Little Bonnechere River. A river of meandering moods brought to life by author, historian and educator **Rory Mackay**:

“When one explores the Little Bonnechere as I have — by canoe or on foot — poking around the old depot farm sites, one begins to hear voices. If one sits long enough at the foot of High Falls or Crooked Chute, one can hear the imaginary sounds of the river drivers of long ago, shouting above the rushing waters. Spend an hour at Dennis McGuey's farm on a summer evening and soon one's mind wanders back to a time when the silence was punctuated by the laughter of pioneer children. How adventurous it must have been to spend one's childhood here.

In truth, no spectres haunt the Basin Depot, McIntyre's Homestead, Armstrong's Stopping Place, or the many untold places where life and death played out their roles. However, the people who lived and worked along the Little Bonnechere continue to exist in the tales of the opening of these lands.”

Rory has been conducting historical research throughout the Little Bonnechere River watershed since the 1970s. His work has included interviews with many of the original depot farm children (most of whom have now passed on), extensive visits to settlement sites, and numerous hours of archival review. The richness of the information has allowed Bonnechere Provincial Park staff to develop a variety of related cultural programs regularly featured throughout the summer months. The Friends of Bonnechere Parks have supported recent research efforts by Rory and are most pleased to be working with him to publish this new chapter in the rich history of the Ottawa Valley.

*The Friends of Bonnechere Park will be hosting a special book signing at Bonnechere Provincial Park on the Spirits Weekend, July 6 and 7, 1996.*

## FRIENDS SAY: *Take a Hike, Eh!*

Celebrate Parks Day by joining the Friends of Bonnechere Parks for a day of hiking in the Little Bonnechere River region. This year we are hosting two hikes on Saturday, July 13. The first, a 5 to 6 km historic hike to High Falls on the Bonnechere River which departs from Basin Depot, Algonquin Park, at 9:30 am, will take approximately 3 hours. After a picnic lunch, join us on a 2 to 3 km nature hike through Bonnechere Park. Departing the Davenport Centre at 2 pm, this hike should end at about 3:30 pm.

Be sure to pack a healthy picnic lunch, wear comfortable clothing and footwear to reflect the weather, and bring plenty of sunscreen. There is no fee to participate in Take A Hike day — but each vehicle will require a day use permit, unless participants are camping overnight in the Park.

This event is one of over 200 Take A Hike events happening across Canada. Take A Hike is a national Parks Day event coordinated by the Canadian Parks Partnership to help raise awareness and support for Canada's Parks and Historic Sites.

Parks Day, a Federal Provincial Parks Council initiative is being held annually mid-July to celebrate the importance of parks in our lives.

The Canadian Parks Partnership is the nation-wide alliance of non-profit friends of organizations who are dedicated to the support and enhancement of Canada's parks and historic sites.



**Saturday, July 13**

## Blueprint for Preserving Bonnechere's Past and Promoting our Future

Plans to develop the Bonnechere Cultural Resource Centre are moving right along. The building will be a multi-use facility incorporating space for interpretive programs, research facilities, resource library, display areas and the Friends headquarters. Modest on-site lab facilities will allow researchers space to clean, identify and store artifacts. The Friends have now proceeded to the blueprint stage and are excited about having a visual representation to work with. The project objectives are as follows:

- provide adequate facilities for a variety of interpretive programming
- establish a repository of information and artifacts from the Little Bonnechere River Watershed
- establish a resource library and create a user-friendly data base of all published and unpublished cultural resource information pertaining to the area
- provide a headquarters for the Friends of Bonnechere Parks and a work centre for the Bonnechere Cultural Project

The multi-functional design of the building will provide facilities for a wide range of programs and research not currently available in the area. By adopting a watershed approach to cultural research it is felt that this ongoing project will serve as a model for other research endeavors. Providing adequate facilities will be key to the preservation and display of project finds. Educational opportunities will be greatly enhanced and public awareness can be focused on the importance of heritage protection.

With blue prints now in hand, the Friends will start to raise funds towards construction of the new structure. The next stage is developing a concerted fundraising program which will include focus on both corporate and private support. A portion of the revenues generated by the publication of *Spirits of the Little Bonnechere* will be invested in this project. While no completion date has been established, we are optimistic that it will be completed in the next few years.

*The Cultural Resource Centre will be an extension of the existing Davenport Centre which overlooks Round Lake at Bonnechere Provincial Park.*

*Right: floorplan.*

*Below: west elevation.*

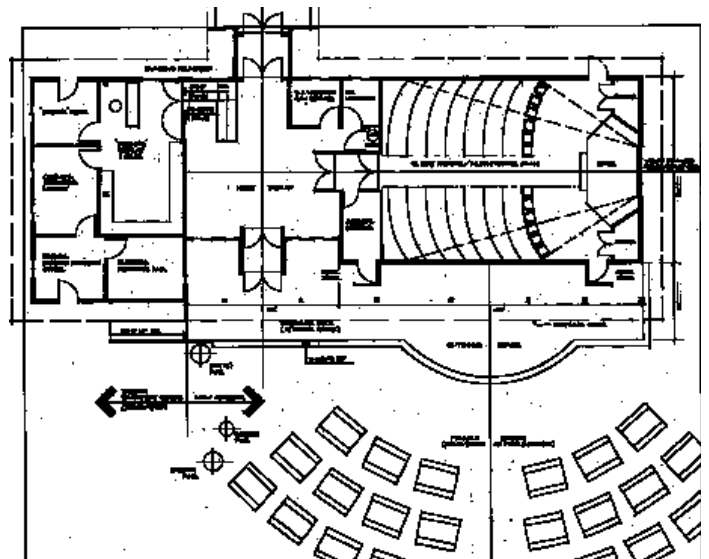

## THE BONNECHERE CULTURAL HERITAGE PROJECT

In 1994, The Friends of Bonnechere Parks, the Ministry of Culture, Tourism and Recreation, The Ontario Archaeological Society and Bonnechere Provincial Park hosted the Archaeology of the Bonnechere Region Conference and Workshop. This week-long conference was intended to bring researchers from a variety of backgrounds and interests together to examine and discuss the cultural resources of the Bonnechere Region. The gathering of this information would assist park staff in future management of the resources and provide the basis for educational programs.

Conference participants exchanged a tremendous amount of information, but realized that the cultural resources of this area still remain largely undiscovered. The creation of a working group to be known as the Bonnechere Cultural Heritage Project, provided for future cultural resource study focusing on the Bonnechere River watershed from Wilbour Lake upstream to the headwaters in Algonquin Provincial Park. Goals and objectives of the project include:

- to conduct a comprehensive inventory of heritage sites along the Bonnechere River from Round Lake to the headwaters
- to compile and create a user-friendly database consisting of all pertinent published and unpublished materials
- to assist with the establishment of a central repository of information and artifacts at Bonnechere Provincial Park
- to develop educational programs highlighting the importance of cultural resource recognition and protection

Parks visitors have already benefitted from the efforts of this hardworking group of volunteers. Educational programs to date have included:

- Minister of Culture Tourism and Recreation Archaeologist Chris J.-Andersen who has provided resource protection training to park staff, and delivered evening programs on Valley archaeology
- Author/Historian/Educator Rory MacKay who, in addition to his ongoing historic research brought his blacksmith shop to the Park for a demonstration
- Archaeology in the Park Weekend provided by the Ottawa Valley Chapter of the Ontario Archaeological Society
- Spirits Nights featuring historic facts provided from ongoing research efforts

To date over seventy cultural sites have been located along the Bonnechere River watershed with many new areas being discovered. Efforts in 1995 have focused on mapping and research of sites. This spring the Friends conducted a site inventory of two areas within the watershed. The inventory work included scientific examination, documenting, and mapping of the features of the sites.

In conjunction with this ongoing research, The Friends of Bonnechere Parks have established a committee to assist and support the work of this project. Committee efforts will focus on the establishment of a multi-functional research centre, supporting the ongoing research efforts, and promotion of cultural awareness through educational programs.

Those interested in reading the report produced by Chris J.-Andersen entitled *The Cultural Heritage Resources of Bonnechere Provincial Park and Environs: An Initial Appraisal*, should send a stamped, self-addressed 9" x 12" envelope to The Friends of Bonnechere Parks, Box 220, Pembroke, ON K8A 6X4. Please mark Andersen in the upper left corner of the envelope.

## SUMMER OF '96

July 6 and 7

Spirits of the Little Bonnechere River

July 13 and 14

Celebrate Parks Day: Take a Hike, Eh!

July 20 and 21

Tall Tales

July 27 and 28

Ottawa Valley Fiddlers

August 3 and 4

Spirits of the Lake

August 9 and 10

Friends Weekend

*Friday: Nature's Visitors*

*Saturday: Natural Heritage activities including guided canoe hikes, Friends' AGM, habitat improvement demos, Songs of Nature campfire*

August 17 and 18

Archaeology of the Ottawa Valley

August 24 and 25

Come Howl at Bonnechere Wolf Howl

*Our ever popular Kids Camp will be back featuring cultural and natural heritage programs on Tuesday, Thursday and Saturday mornings.*

## Survey Says...

**The Bonnechere Provincial Park in the Year 2000 Survey** which we conducted last summer resulted in some useful management planning information:

**89%** agreed children's programs are beneficial,

**79%** want the full range of programs to continue,

**78%** support the development of a Cultural Resource Centre,

**66%** would camp in a rustic cabin in a provincial park,

**58%** would use electrical campsites,

**53%** want year round activities including wolf howls, sleigh rides, cross-country skiing, cultural resource workshops,

**53%** would use a site-specific reservation system.

## 1996 Membership Drive — New Members Welcome!

It's renewal time and your 1996 Membership card is attached. If you are not already a member of the Friends of Bonnechere Parks, but would like to be, now is the time to join. We ask that you complete the following and send your payment via return mail.

NAME

STREET

CITY

PROVINCE

POSTAL CODE

PHONE

MEMBERSHIP  new  renewal

CATEGORY  individual (\$10)  family (\$15)

Friends of Bonnechere Park are entitled to 10% off all purchases made at the Bonnechere Park Book Shop.

*Tax receipts will not be issued for memberships.*

## We Now Take Reservations

While we endeavour to keep things the same at Bonnechere Park, there will be some improvements to services and amenities this season. After much discussion and study, a modified campsite reservation system will be implemented on a trial basis for the 1996 summer season.

In July and early August, 24 campsites will be available for minimum one-week reservation (Sunday noon thru Sunday noon). Shorter reservations during this period will not be available as most of our customers come for the week and we do not want to displace long-term campers by those wishing to spend only a weekend. During non-peak season, campsites traditionally not filled by first-come-first-served will be available for reservation. This will allow visitors to base their travel plans on firm availability of a campsite.

Reservations can be made beginning May 1, 1996. Park staff will require: arrival and departure dates, name and address, number in party, vehicle license number, electrical site requirements, and a valid Visa or MasterCard with expiry dates. If you wish to take the worry out of arriving here to find the Park Full sign up, plan ahead and give us a call:

**PARK RESERVATIONS: 1-613-757-2103**

## Return of the Bookstore!

If you're planning a trip to the Park this summer, make sure that a visit to the Bookstore in the Davenport Centre is at the top of your list of things to do. The Friends would love to see you!

While holidays are a real treat for us all, sometimes the time can drag for those of us who aren't used to sitting in one place for very long. If that's the way it is for you, the Friends have the perfect solution. Consider donating a few hours of your time to working in the Bookstore. It's a great way to meet new friends and to get to know the Park better. Those interested in volunteering should contact Vicki Bradley at 613-732-7732, or drop a note to 283 Supple Street, Pembroke, ON K8A 3H3.

## Marshall the Wood Turtle's Excellent Travel Adventure Contest

Until August 6, 1996, we will be accepting entries in our **Marshall the Wood Turtle's Excellent Travel Adventure Contest**. Just send us a photograph of yourself wearing an official Marshall t-shirt at your favourite and/or most exotic travel destination (besides Bonnechere Park, of course) along with a short write-up about why this place is special to you. All photos will be on display at the Davenport Centre during the upcoming summer, and at next year's AGM the Board of Directors will vote on Marshall's most unique travel destination.

### Contest Rules

- restricted to purchasers of an authentic Marshall the Wood Turtle t-shirt
- send a 3" x 5" non-returnable photo and a short descriptive paragraph to:  
Friends of Bonnechere Parks, Marshall the Wood Turtle's Excellent Travel Adventure Contest, Box 220, Pembroke, ON K8A 6X4

### Contest Prizes

- **Grand Prize:** 2 nights free camping at Bonnechere Provincial Park, an authentic Park Ranger sun hat, an official Take-a-Hike walking stick and a Friends of Bonnechere Parks sweatshirt
- **Second Prize:** a Friends of Bonnechere Parks sweatshirt and lapel pin

## Order your special Marshall t-shirt today!

Get yours before they're *snapped up!*

Poly-cotton. Sizes: S, M, L.  
Colours: teal, purple, yellow, blue, green.

**15<sup>00</sup>** taxes inc.

*To order, please add \$4.00 for shipping.*

*Send cheque or money order only.*

*Make cheques payable to Friends of*

*Bonnechere Park, Box 220, Pembroke, ON K8A 6X4*

*Please allow 3 to 4 weeks for delivery.*

*Sorry, we cannot guarantee colour choice.*

